

# TOWN OF BELVILLE ZONING MAP

## LEGEND ZONING DISTRICTS

- R10 = RESIDENTIAL DISTRICT
- R15 = RESIDENTIAL DISTRICT
- MF = MULTI-FAMILY DISTRICT
- MH = MANUFACTURED HOMES DISTRICT
- BR = BUSINESS RESIDENTIAL DISTRICT
- BH = BUSINESS HIGHWAY DISTRICT
- CBD = CENTRAL BUSINESS DISTRICT
- I = INDUSTRIAL DISTRICT
- PI = PUBLIC INSTITUTIONAL DISTRICT
- RR = RESOURCE & RECREATION DISTRICT
- REVISED PARCEL DATA OBTAINED SINCE 2011 OFFICIAL ZONING MAP PUBLISHED
- Unincorporated Areas
- Town of Belville (Corporate Limits)

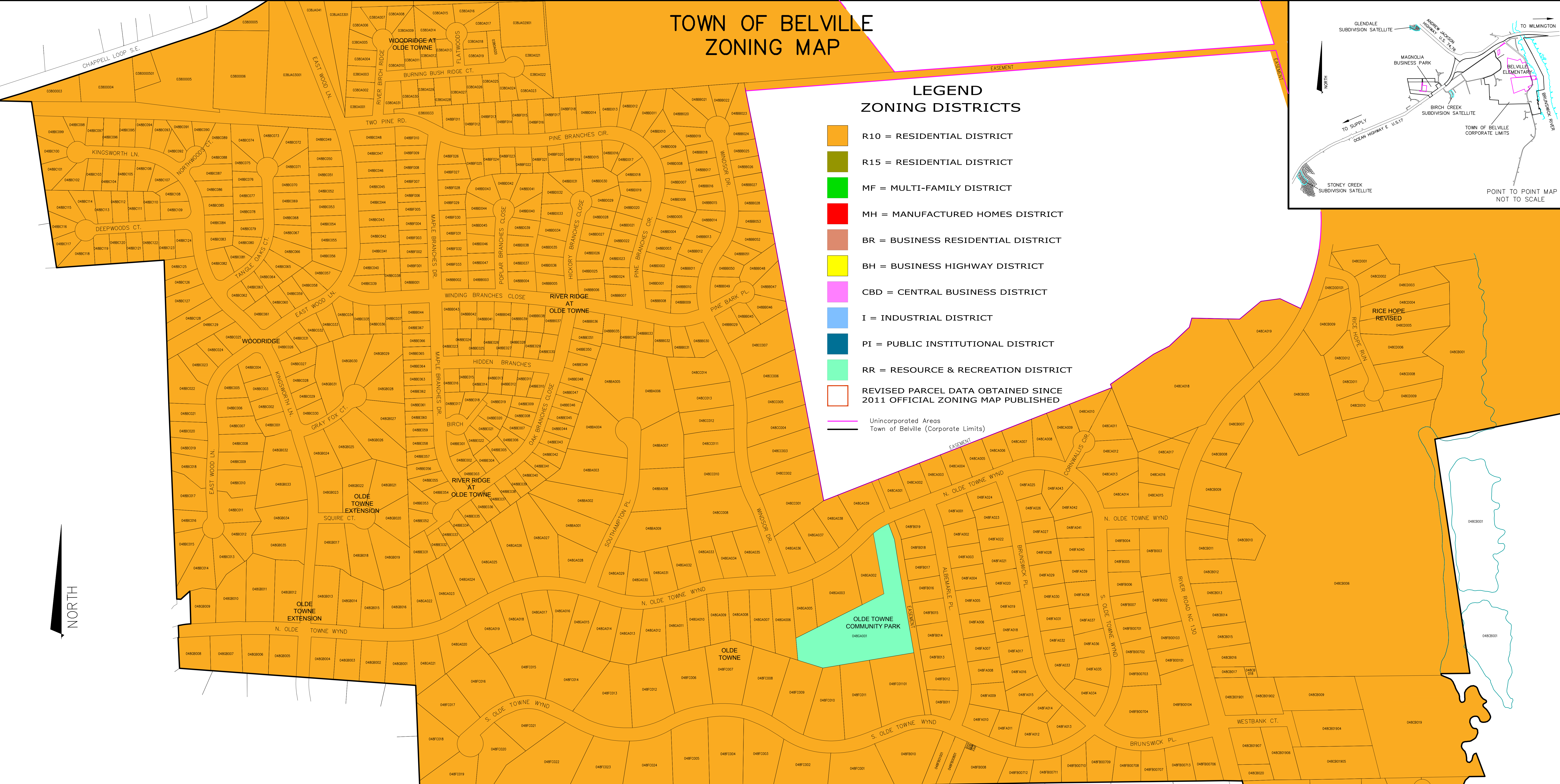
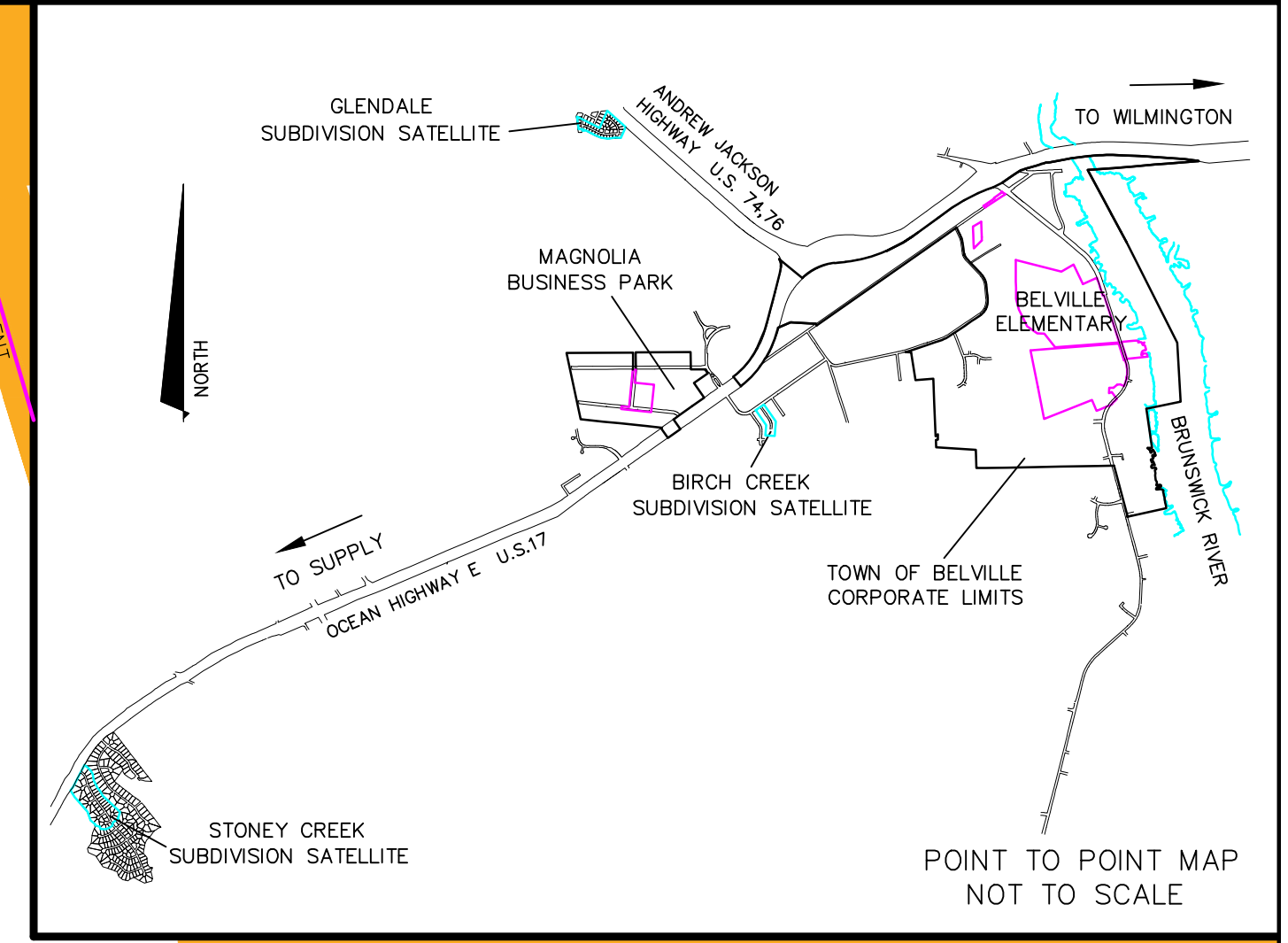

### PUBLIC HEARING MAP FOR THE 2013 TOWN OF BELVILLE ZONING MAP

NOTE: This map is for informational purposes only. The information shown was compiled from record information, as provided by Brunswick County, NC & The Town of Belville, NC.

**NORTH STATE SURVEYORS PLLC**  
**OWEN GIDLOW, PLS**  
 15 TOPSAIL COURT  
 CAROLINA SHORES, NC 28467  
 (910) 579-4617  
 ogidlow2@yahoo.com  
 NORTH CAROLINA PROFESSIONAL CORPORATION P-0982  
 1" = 300' SCALE ON 20" X 14" KEY SHEET ONLY  
 © COPYRIGHT 2013 NORTH STATE SURVEYORS PLLC

AMENDMENTS			
#	PLANNING BOARD	TOWN COUNCIL	DESCRIPTION

THIS IS TO CERTIFY THAT THIS OFFICIAL ZONING MAP, SUPERSEDES AND REPLACES ANY PREVIOUS OFFICIAL ZONING MAP ADOPTED BY THE TOWN OF BELVILLE AS PART OF THE ZONING ORDINANCE, TOWN OF BELVILLE, NORTH CAROLINA.

MAYOR \_\_\_\_\_  
 ATTEST: \_\_\_\_\_  
 TOWN CLERK \_\_\_\_\_  
 DATE \_\_\_\_\_

SEAL

DULY ADOPTED BY THE BELVILLE BOARD OF COMMISSIONERS ON \_\_\_\_\_

