

TOWN OF BELVILLE ZONING MAP

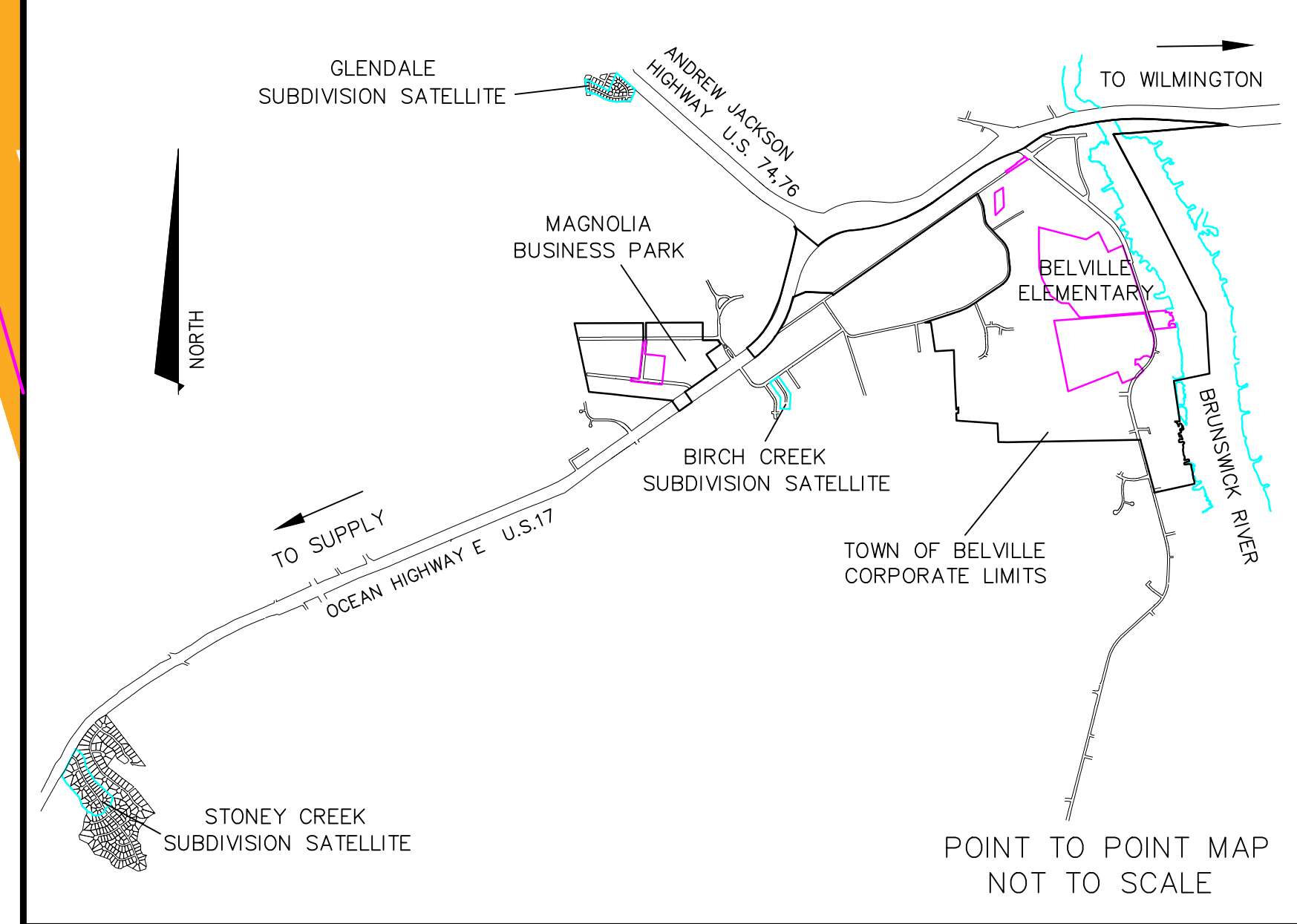

LEGEND ZONING DISTRICTS

- R10 = RESIDENTIAL DISTRICT
- R15 = RESIDENTIAL DISTRICT
- MF = MULTI-FAMILY DISTRICT
- MH = MANUFACTURED HOMES DISTRICT
- BR = BUSINESS RESIDENTIAL DISTRICT
- BH = BUSINESS HIGHWAY DISTRICT
- CBD = CENTRAL BUSINESS DISTRICT
- I = INDUSTRIAL DISTRICT
- PI = PUBLIC INSTITUTIONAL DISTRICT

- REVISED PARCEL DATA OBTAINED SINCE 2011 OFFICIAL ZONING MAP PUBLISHED
- Unincorporated Areas
- Town of Belville (Corporate Limits)

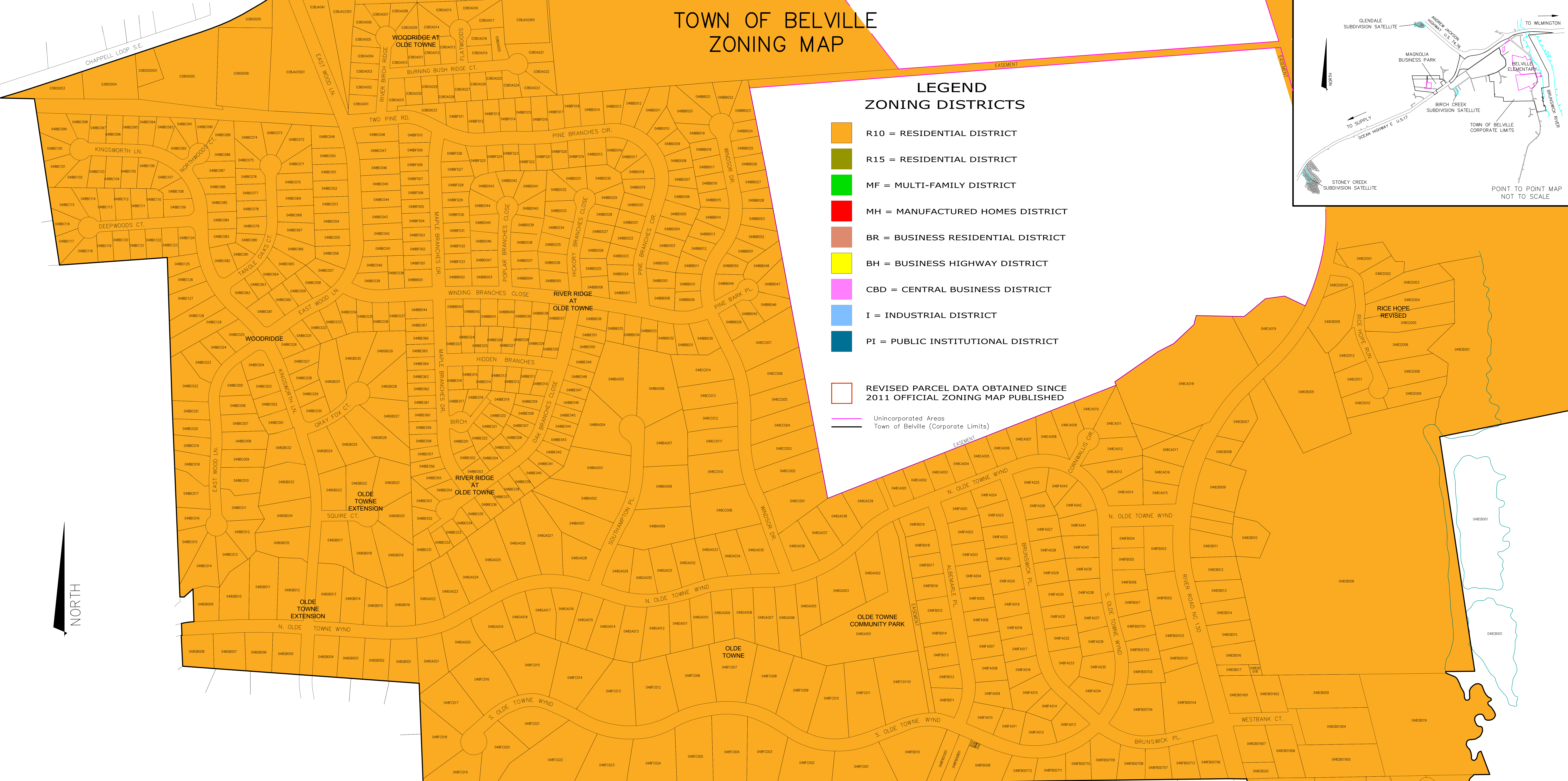

PUBLIC HEARING MAP FOR THE 2013 TOWN OF BELVILLE ZONING MAP

NOTE: This map is for informational purposes only. The information shown was compiled from record information, as provided by Brunswick County, NC & The Town of Belville, NC.

NORTH STATE SURVEYORS PLLC
OWEN GIDLOW, PLS
 15 TOPSAIL COURT
 CAROLINA SHORES, NC 28467
 (910) 579-4617
 ogidlow2@yahoo.com
 NORTH CAROLINA PROFESSIONAL CORPORATION P-0982

1" = 300'
 SCALE ON 30" X 42" SHEET ONLY
 © COPYRIGHT 2013 NORTH STATE SURVEYORS PLLC

CHECKED BY: OGG
 SCALE: NOT TO SCALE
 TOWNSHIP: TOWN CREEK
 COUNTY: BRUNSWICK
 STATE: NORTH CAROLINA

DATE: 7 OCTOBER 2013
 FIELD BOOK: -
 FILE: PUBLIC HEARING MAP2013
 JOB NO.: 12018

AMENDMENTS			
#	PLANNING BOARD	BOARD OF COMMISSIONERS	DESCRIPTION

THIS IS TO CERTIFY THAT THIS OFFICIAL ZONING MAP, SUPERSEDES AND REPLACES ANY PREVIOUS OFFICIAL ZONING MAP ADOPTED BY THE TOWN OF BELVILLE AS PART OF THE ZONING ORDINANCE, TOWN OF BELVILLE, NORTH CAROLINA.

MAYOR
 ATTEST:
 TOWN CLERK
 DATE

SEAL
 DULY ADOPTED BY THE BELVILLE BOARD OF COMMISSIONERS ON _____

